

CP1

FLUXFORT



fluxfort.com

Specifications

Max Flow:	2GPM
Max Head:	15PSI
Max Fluid Temp:	180degF (82degC)

Materials in Contact with Fluid

Body:	Biocompatible
Impeller:	Biocompatible
Shaft / Seal:	SS304 / Nitrile

Motor Specifications

Voltage (DC):	12V
Amps:	2A
Motor Type:	Brush
PWM Control:	Capable (8kHz)

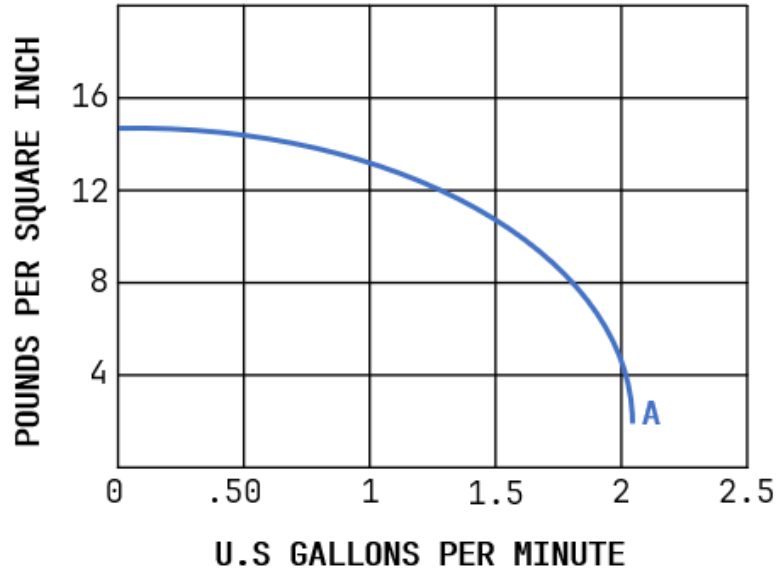

DO NOT RUN PUMP DRY

Dimensions in mm

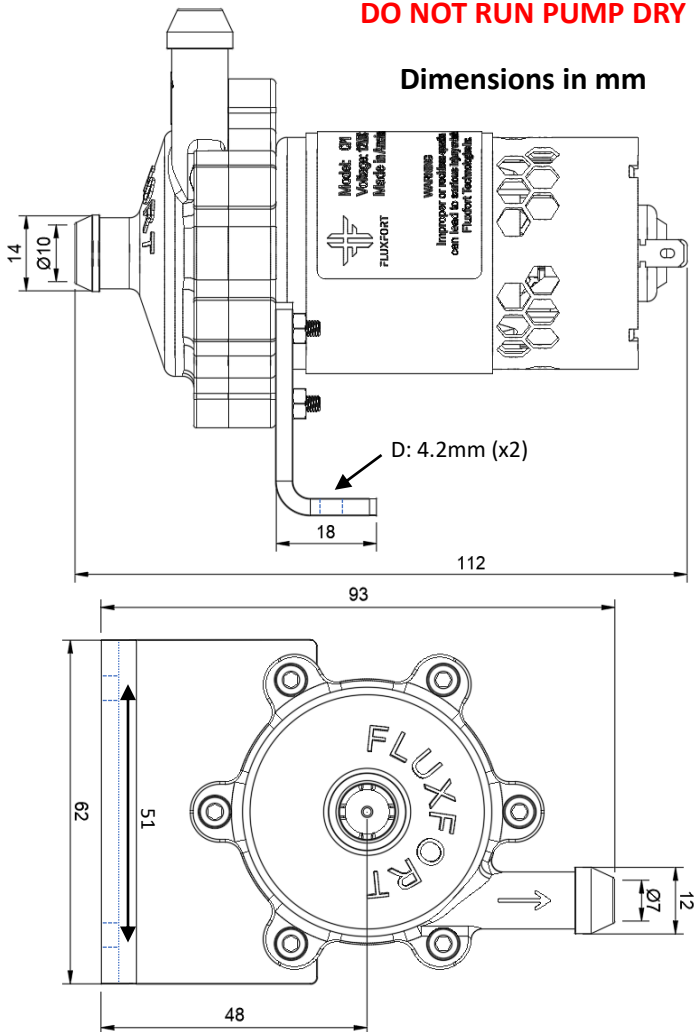

Fluxfort Technologies Inc.

Address: 5500 Cerritos Ave. Unit F.
Cypress CA 90630 USA

Email: hello@fluxfort.com

Phone: +1 (714) 820-6007

